

1200 DL- High Performance Thermal Printer/Plotter

FOR DATA LOGGING AND LOG ANALYSIS APPLICATIONS

LOAD PAPER WITHOUT THREADING OR ALIGNMENT

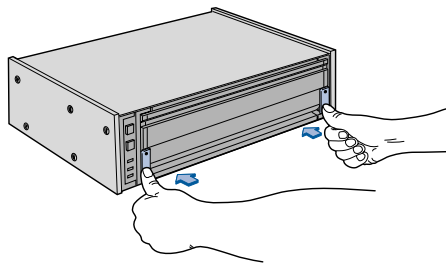

Unlock Door

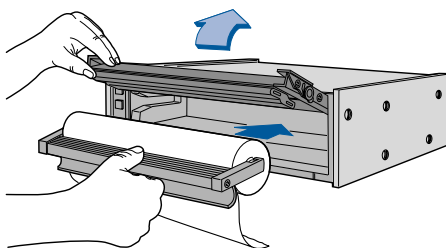

Insert Roll In Printer

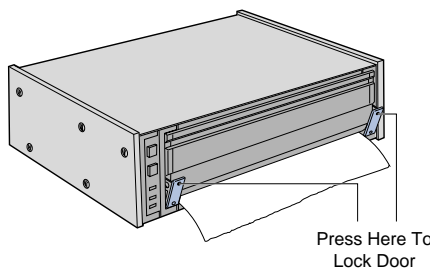

Press Here To Lock Door

Lock Door

Printrex plotters feature an innovative paper handling system that permits the user to reload paper in seconds without any threading or alignment. The operator simply inserts the paper carrier, closes the door and is ready to print.



High performance thermal printers/plotters for Original Equipment Manufacturers

Printrex produces high performance printers/plotters for Original Equipment Manufacturers. These products get integrated into a wide range of medical, industrial and scientific instruments. They are used to plot data in EEGs, ophthalmology and ultra sound devices. They are installed in railroad locomotives and in jet aircraft. The rugged reliability and innovative paper handling are the characteristics that make Printrex the choice in these diverse applications.

The Printrex 1200 DL along with the smaller 820 DL has been configured with the features required for data logging and log analysis applications.

They print/plot on regular thermal rolls, on fan fold paper and on thermal transparencies. An optional paper tray is available.

1200 DL High Performance Thermal Printer/Plotter

PERFORMANCE SPECIFICATIONS

Alphanumeric Mode

Print rate of 6 or 3 character lines/second
96 ASCII characters and 128 graphic characters
Double high and double wide print
Inverted and reverse image characters
International character sets
6.25 or 12.5 character lines/inch
Line length is 11 inches (280 mm)

Character Format

Alphanumeric Character Format:

Pitch	Number of Dots Wide	Number of Dots High	Number of Characters/Line
10	20	32	112
12	16	32	140
16.7	12	32	186
20	10	32	224

Graphics Characters: May occupy any position in the above matrices

Bit Mapped Graphics Mode

Plot speed: 1.0 or 0.5 inches/second
100 x 100 dots/inch or 200 x 200 dots/inch (nominal)
Horizontal dot density: 203 dots/inch (8 dots/mm)
Vertical dot density: 201 dots/inch (8 dots/mm)
Line length: 11.65 inches(296 mm), 2,368 dots

Hardware Interface

Centronics type parallel.

Print Drivers

Printrex provides printer drivers to use the 1200 DL with Windows[®] 95 and Windows NT[™] Version 4.0

Media Specifications

Standard thermal rolls, fan fold forms with forms mark and thermal transparencies

Media Dimensions: 11-³¹/₃₂" ±¹/₃₂" (304 mm ±0.75mm)

Maximum Roll Diameter: 2.6" (66mm)

Physical Characteristics

Dimensions: 4.87" H x 15.6" W x 12.0" D
(12.4 x 39.6 x 30.5 cm)

Shipping Weight: 22 lbs. (10 kg)

Environmental

Operating Temperature: +41 to +104° F (+5 to +40° C)

Storage Temperature: -40 to +140° F (-40 to +60° C)

Acceleration (Non-Operating): +3G, 0 to 50 Hz, 3 axes

Windows is a registered trademark and Windows NT is a trademark of Microsoft Corporation.



276 East Gish Road
San Jose, California 95112
Telephone: (408) 573-1200
Fax: (408) 573-1600
www.printrex.com

Represented By: